



Features

- Intel® Broadwell i7/i5 CPU
- 19" 1280x1024 LCD Panel
- Chassis Type w/P-Cap Touch
- Full Flat Design Easy Clean & IP66 Front
- Wide Range DC Input
- Optional WLAN with External Antenna
- Optional 2nd HDD

Specification

Product		WLP-7D20-19V CKPT
Main System	CPU	5th generation Intel® Core i7/i5/i3 processor
	Graphic	Intel® integrated HD Graphics 5500 by CPU
	Memory	Two 1600 MHz DDR3L SODIMM socket support dual Channel, non-ECC, up to 16GB
	OS Support	Win 7pro, Win 8, Win 8.1 industrial
Display	Size	19" 4:3
	Resolution (pixel)	1280 x 1024 (SXGA)
	Number of Colors	16.7M colors (RGB 6-bit + Hi FRC)
	View Angle (H/V)	170(H) / 160(V)
	Brightness(cd/m ² , nit)	350 nits
	Contrast Ratio	1000:1 (Typ)
Touch Panel	Type	Chassis projective capacitive touch panel
	Light Transmission	90 ± 3%
	Hardness	7H
	Lifetime	100M times
Storage & Expansion	Storage	2.5" SATA HDD drive bay x 1 up to 500GB w/Anti-Vibration Kit, optional 2 nd HDD
	Expansion	Mini PCIe x 2
I/O Ports	USB	USB 3.0 x 2, USB 2.0 x 2
	COM	2 X RS-232, 1 XRS-232/422/485
	LAN	2 x RJ-45
	Audio/ Video	3.5mm phone jack connector x 2 (Line-out, Mic-in)/ DP x 2
	Control Keys	Rear bottom: Power on /off
Power	Power input	DC-in x 1, 7~32V
	Power adapter	External, 60 watts, universal 100 ~240V AC in, 12V DC out, 6.66A
Environmental	Temperature	Operating Temperature: 12V DC Input 0~50°C (air flow cooling) Storage Temperature: -20~60°C
	Humidity	Operating & Storage: 10 ~ 90%, non-condensing
	Water/Dust resistance	IP66 at front
Mechanical Characteristics	Housing	Front bezel is Aluminum, others are SECC with black coating
	Dimensions (Net: mm)	495.5 (H) x 384.7 (V) x 91.5 (T)
	Weights (Net: kg)	9.2 kg
	Mounting	Chassis, VESA (75x75)
Certification	CE/ FCC/ VCCI Class B	

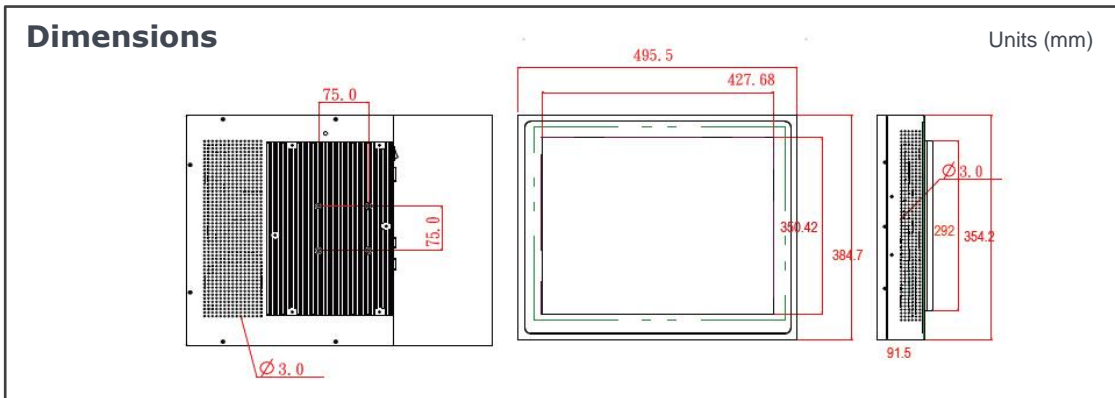

Major Options

Add On Parts	<ol style="list-style-type: none"> 1. Wireless or Wireless + BT kit , 2. mSATA module, 3. Stainless front bezel, 4. Silver front bezel, 5. TPM 2.0, 6. 2.5" SSD, 7. 2nd HDD
Add On Cable	1.DC input power plug (black, 1.22m length)
Customized	<ol style="list-style-type: none"> 1. Open frame housing, 2. Sunlight readable optical bonding, 3. LCD auto dimming, 4. LCD super dimming (Low brightness), 5. Storage door Solution

Order Information

Item	Touch	Description
WLP-7D20-19V (CKPT)	Chassis P-cap.touch	19" Core i5-5200U/ 4G RAM/ 500G HDD

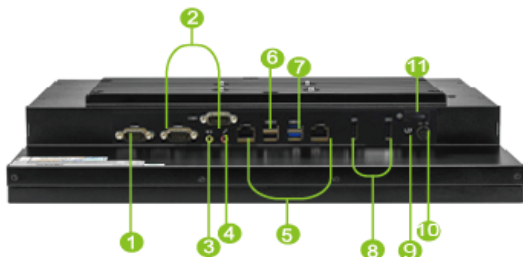

- ① RS232/422/485
- ② RS232 x 2
- ③ Line out
- ④ Microphone-in
- ⑤ LAN x 2
- ⑥ USB 2.0 x 2
- ⑦ USB 3.0 x 2
- ⑧ DP x 2
- ⑨ Reset
- ⑩ DC-in
- ⑪ Power on/off

