



Features

- Intel® 6th / 7th Generation i7/i5/i3 CPU
- 17" 1280x1024 LCD Panel
- Panel Mounted with Full Flat Touch
- CE, FCC, VCCI Class B Certified
- Support Intel® vPro by CPU
- IP66 Front Easy to Clean
- Wide Range DC Input
- Optional WLAN with External Antenna
- One M.2 / One Mini-PCIe Expansion

Specification

Product		WLP-7F20-17 BKFT	WLP-7F20-17 BKPT
Main System	CPU	6th generation Intel® Core i7/i5/i3 processor 7th generation Intel® Core i7/i5 processor	
	Graphic	Intel® integrated HD Graphics by CPU	
	Memory	Two 2133 MHz DDR4 SODIMM socket support dual Channel, non-ECC, up to 32GB	
	OS Support	Win 7, Win 7 Pro, Win 8, Win 10	
Display	Size	17", 5:4	
	Resolution (pixel)	1280 x 1024 (SXGA)	
	Number of Colors	16.2M colors	
	View Angle (H/V)	170(H) / 160(V)	
	Brightness(cd/m ² , nit)	350 nits	
Contrast Ratio	1000:1 (Typ)		
Touch Panel	Type	Full flat resistive touch panel	Full flat projected capacitive touch panel
	Light Transmission	80 ± 5%	90 ± 3%
	Hardness	3H	7H
	Lifetime	35M times	100M times
Storage & Expansion	Storage	2.5" SATA HDD drive bay x 1 (with anti-vibration mechanism)	
	Expansion	Mini PCIe x 1, M.2 Type E x 1	
I/O Ports	USB	USB 3.0 x 4	
	COM	2 X RS-232, 1 X RS-232/422/485	
	LAN	2 x RJ-45	
	Audio / Video	3.5mm phone jack connector x 2 (Line-out, Mic-in) / DP x 2	
	Control Keys	Rear bottom: Power on /off	
Power	Power input	DC 9 ~ 32V, DC 12V, optional DC 12 (by DC-DC adapter)	
	Power adapter	External, 100 watts, universal 100 ~240V AC in, 12V DC out, 8.33A	
Environmental	Temperature	Operating Temperature: 0~50°C (12V DC , air flow cooling) Storage Temperature: -20~60°C	
	Humidity	Operating & Storage: 10 ~ 90%, non-condensing	
	Water/Dust resistance	IP66 at front	
Mechanical Characteristics	Housing	Front bezel is Aluminum, others are SECC with black coating	
	Dimensions (Net: mm)	426.2 (H) x 358.6 (V) x 90 (T)	
	Weights (Net: kg)	8.5 kg	
	Mounting	Panel mount, Optional Open frame / Chassis, VESA (75x75)	
Certification	CE/ FCC/ VCCI Class B, Canada ICES-003		

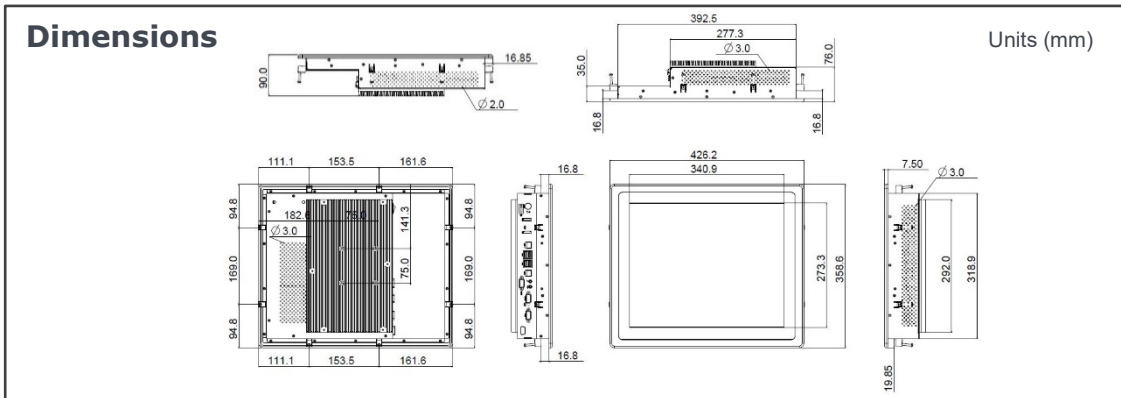

Major Options

Add On Parts	<ol style="list-style-type: none"> 1. Wireless or Wireless and BT kit 2. 2.5" SSD 3. Stainless steel front bezel 4. Change full flat resistive touch to P-cap touch (BKPT) 5. Silver front bezel 6. Storage door Solution 7. mSATA module 8. TPM 2.0, 9. Chassis type housing
Add On Cable	<ol style="list-style-type: none"> 1. DC input power plug (black, 1.22m length) 2. Maximum length is 5.2 meters by 2x2m DC cables
Customized	<ol style="list-style-type: none"> 1. Open frame housing 2. Sunlight readable optical bonding 3. LCD auto dimming 4. LCD super dimming (Low brightness)

Order Information

Item	Touch	Description
WLP-7F20-17 (i5)	Full Flat Resistive Touch	17" Core i5-7200U/ DDR4 4G RAM/ 500G HDD

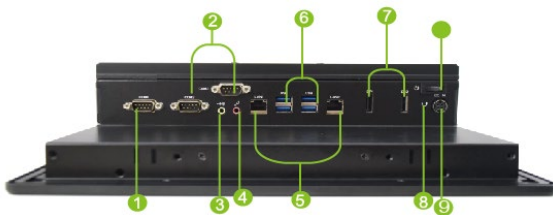

- ① RS232/422/485
- ② RS232 x 2
- ③ Line out
- ④ Microphone-in
- ⑤ LAN x 2
- ⑥ USB 3.0 x 4
- ⑦ DP x 2
- ⑧ Reset
- ⑨ DC-in
- ⑩ Power on/off

